

Yealink Wireless Touch-Sensitive Conference Phone

Yealink CP935W is a wireless touch-sensitive HD conference phone designed for small to medium conference room. CP935W adopts a business and introverted design that perfectly matches the calm style of the conference room, also adopts an acoustics fabric, which is impervious to any accidental liquid spills. Its fingerprint-proof LCD screen with a clear UI interaction page makes it easy for everyone to control the meeting. CP935W has built-in battery and Wi-Fi, you can register a SIP account directly through Wi-Fi. CP935W allows you to deploy without using power and network cable to provide you with a wireless and clean conference room. CP935W has 6 built-in microphones, providing you with a clear and natural conference call experience. In addition, you can also connect CP935W to your mobile devices (such as smart phone, personal computer, etc.) through Bluetooth or USB port to realize Hybrid UC meeting.



4" Multi-Touch Screen



Yealink Pentagon Meeting Room



Hybrid UC Meeting



Pairing via Bluetooth



Switchable DECT/Wi-Fi Mode



Built-in Battery



Key Features and Benefits

Modest Design, Easy-to-Use User Interface

Yealink CP935W is a hermit in a conference room. Its black acoustics fabric can realize crystal-clear audio and is resistant to water, oil, and stain. Its ultra-thin body, appropriate desktop fit, and ingenious hidden wiring slot, perfectly fit for the simple business style in the conference rooms. Additionally, its built-in Linux system and easy-to-use UI interface, allow users to launch a meeting with one button and increase user adoption.

Built-in Battery, Wi-Fi and DECT to Minimize Deployment Costs

CP935W has built-in battery and Wi-Fi, you can register a SIP account directly through Wi-Fi. CP935W allows you to deploy without using power and network cable to provide you with a wireless and clean conference room.

HD Audio, Smooth Communication

CP935W adopts Y-shaped design and has 6 built-in microphones for sound pickup. Its 20-foot and 360° omni-direction sound pickup provide users with clear and natural voice conference experience.

Rich Features and High Expandability

CP935W supports 5-way conference call, enabling participants from different locations to communicate smoothly, and reducing costs for your company. You can also connect CP935W to your mobile devices (such as smart phone, personal computer, etc.) through Bluetooth or USB port to realize Hybrid UC meeting (including SIP, mobile phone, PC).

- 4-inch multi-touch screen with 480x800 resolution
- Optimal HD audio, full duplex technology
- Yealink Noise Proof Technology
- Built-in rechargeable lithium battery
- Up to 15 hours talk time (in ideal conditions)
- Up to 75 hours standby time in Wi-Fi mode (in ideal conditions)
- 20-foot (6-meter) and 360° voice pickup
- Built-in 6-microphone array for voice pickup
- 5-way conference call
- Hybrid UC meeting
- Built-in Wi-Fi (2.4GHz/5GHz, 802.11a/b/g/n)
- Built-in Bluetooth 4.2

Audio Features

- Optimal HD audio
- Yealink Noise Proof Technology
- Smart Noise Filtering
- 20-foot (6-meter) microphone pickup range
- Apply to small to medium conference room
- Built-in 6-microphone array for voice pickup
- Loudspeaker
 - Frequency: 100-20,000 Hz
 - Volume: 94dB at 0.5-m peak volume
- 56mm diameter and 5w speaker
- Full-duplex speakerphone with AEC
- Echo cancellation tail length is up to 320ms
- Background noise suppression
- Codecs: G722, G722.1C, G726, G.729, G.729A, G723, iLBC, PCMU (G.711A), PCMA (G.711μ), AMR
- DTMF: In-band, Out-of-band (RFC 2833) and SIP INFO
- VAD, CNG, PLC, AJB, AGC

Phone features

- 1 SIP account
- Call hold, mute, DND, call recording, hotline
- 5-way conference call
- Redial, call waiting, emergency call
- Call forward, call transfer, call return, dial plan
- Ring tone selection/import/delete
- Set date time manually or automatically
- Volume adjustment
- Pairing via Bluetooth
- Create meeting directly
- Join meeting seamlessly
- Active Speaker

Directory

- Local phonebook up to 1000 entries
- XML/LDAP remote phonebook
- Intelligent search method
- Phonebook search/import/export
- Call history: dialed/received/missed/forwarded

- Blocklist

IP-PBX features

- Busy Lamp Field (BLF)
- Multicast paging
- Intercom
- Anonymous call
- Anonymous call rejection
- Voice mail
- Distinctive ringtone
- Call pickup

Display

- 4" 480x800 capacitive touch screen
- Volume key
- Home button

Interface

- Built-in Wi-Fi (2.4GHz/5GHz, 802.11a/b/g/n)
- Built-in Bluetooth 4.2
- 1 x USB 2.0 Type-C device port
- 1 x Security slot

Network and Security

- SIP v1 (RFC2543), v2 (RFC3261)
- SIP server redundancy supported
- IPv4/IPv6
- NAT traversal: STUN mode
- Proxy mode and peer-to-peer SIP link mode
- HTTP/HTTPS web server
- Time and date synchronization using SNTP
- UDP/TCP/DNS-SRV (RFC 3263)
- SRTP for voice encryption
- Transport Layer Security (TLS1.3)
- HTTPS certificate manager
- AES encryption for configuration file (AES256)
- Digest authentication using MD5/MD5-sess
- OpenVPN, L2TP VPN
- WPA2
- Secure boot

Management

- Configuration: browser/phone/auto-provision/Yealink Device Management Platform
- Auto provision via FTP/TFTP/HTTP/HTTPS for mass deployment
- Auto-provision with PnP
- Zero-sp-touch, TR-069
- Reset to factory, reboot
- Package tracing export, system log

Other physical features

- Color: Black
- Wi-Fi range
 - Up to 300 meters, depends on Wi-Fi router
- PSU: 2.2~6W
- Battery capacity: 7800mAh
- Charging time: 4 hours
- Up to 75 hours standby time in Wi-Fi mode (in ideal conditions)
- Up to 15 hours talk time (in ideal conditions)
- Dimension (W*D*H): 288.6mm*285.2mm*63.9mm
- Operating humidity: 10~90%
- Operating temperature: -10 to +45°C (+14 to 113°F)
- Storage temperature: -30 to +70°C (-22 to +158°F)

Package Features

- Package content:
 - Yealink CP935W IP conference phone
 - Charger cradle
 - Yealink Power Adapter
 - Quick Start Guide
- Qty/CTN: 5 PCS
- N.W/CTN: 7.416 kg
- G.W/CTN: 8.420 kg
- Giftbox size: 355mm*349mm*108mm
- Carton Meas: 567mm*357mm*365mm

Compliance

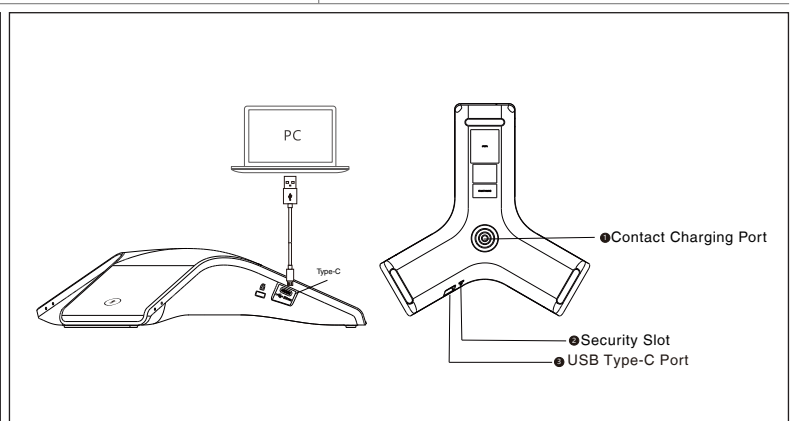
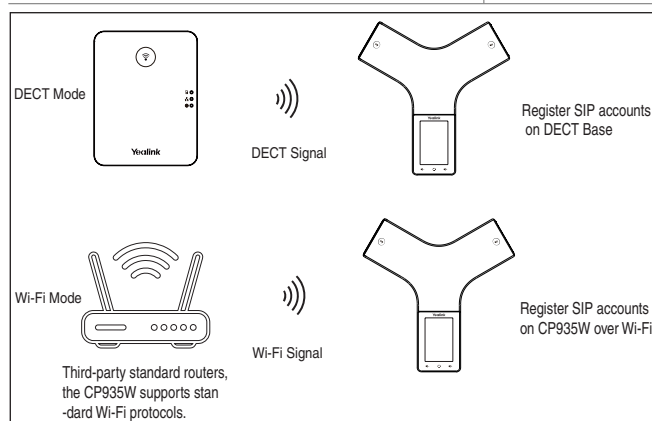

The datasheet focuses on Wi-Fi mode, please refer to CP935W-Base if you want to learn more about DECT mode.